

Motor Bracket MBC20H / MBC25

Fig→Fixed+Fixed

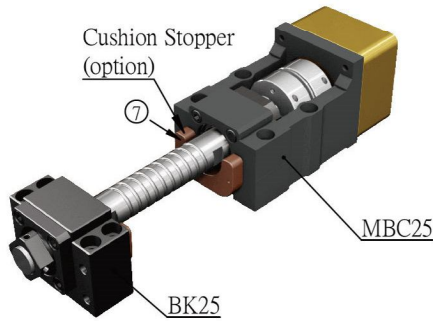

Fig→Fixed+Supported

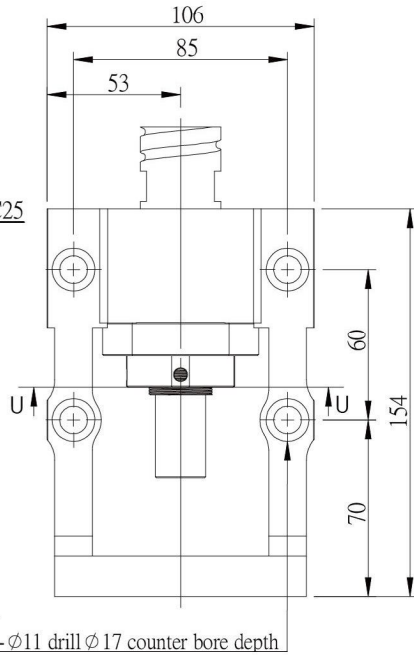
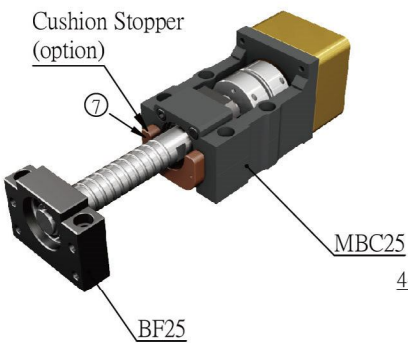

Surface treatment: Black Oxide

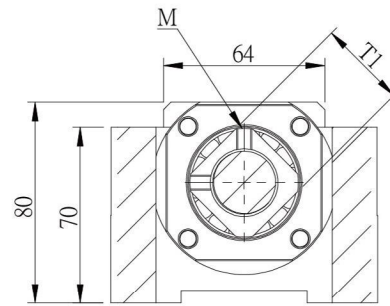

Section U-U

No.	Part name	Qty
1	Housing	1
2	Bearing MBCF20H with bearings 7204 MBCS20H with bearings 20TAC MBC25 with bearings 7205	1set
3	Holding lid	1
4	Collar	2
5	Seal	2
6	Lock nut	1set
7	Cushion Stopper (option)	1

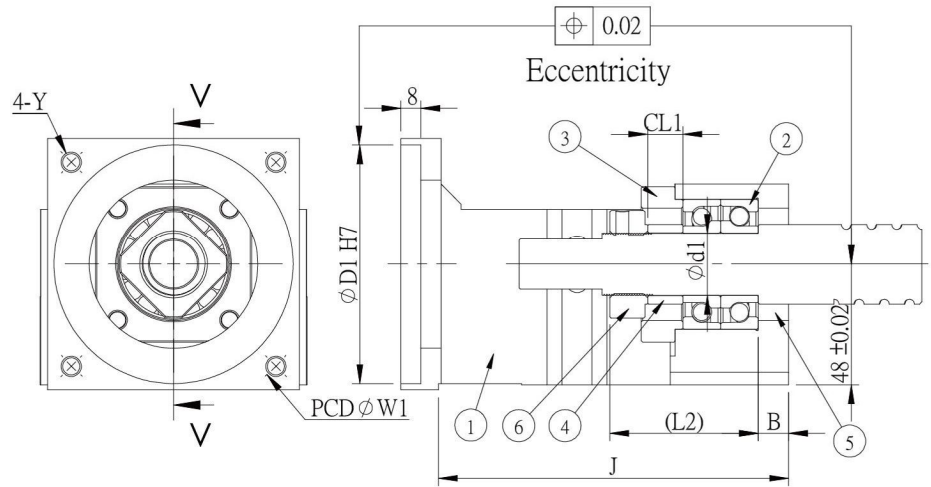

Section V-V

Unit : mm

Model No.	D1	W1	Y	J	Shaft diameter d1	CL1	B	L2	M	T1	Weight (Kgs)	Support unit	Suggest Coupling							
												Supported-side								
MBCF20H-X	80	100	M6	flat	20	11	9	50	2-M4	□30	-	SK20	SGL 50C							
MBCS20H-X												SF20		SGL 57C						
MBC25-X	80	100	M6	flat	25	14	12	59	2-M6	□35	4.51	BK25	SGS 57C							
MBC25-Y														95	115	M8	139	4.43	BF25	SGS 65C
MBC25-YP																M6				

Note : 1. The matched bearing in the support unit has already done the preload.

2. The matched bearings are assembled in DF way, which is the most suitable for ball screw use.

3. The accuracy of TAC bearing is P4 grade and 7204、7205 is P5 grade.



Illustration for MBC25

Fixed+Fixed

Pattern: Servo motor
 DELTA C11020
 MITSUBISHI HC-RP103~203
 □100X100

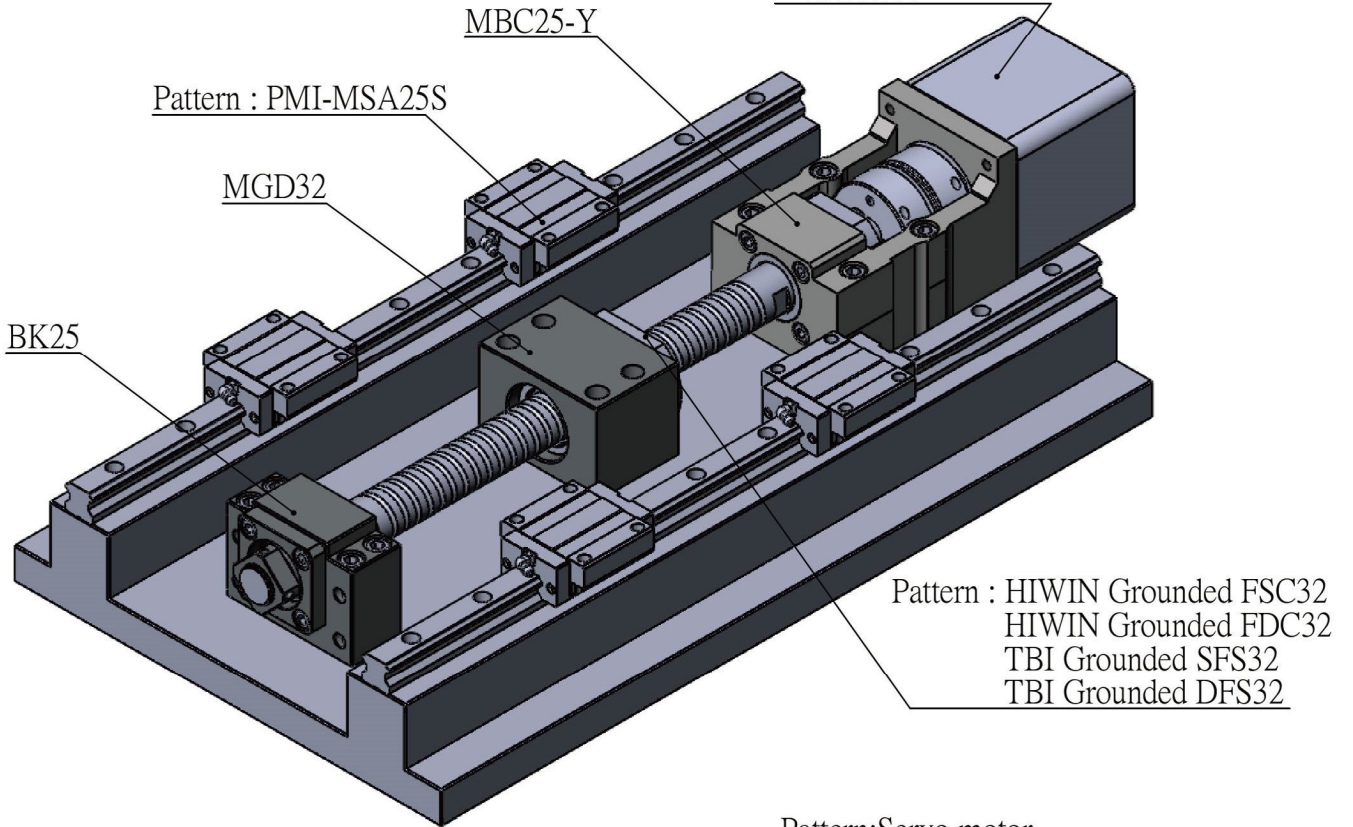

Fixed+Supported

Pattern: Servo motor
 DELTA C11020
 MITSUBISHI HC-RP103~203
 □100X100

