

Motor Bracket MBCS25/30 / MBCF30

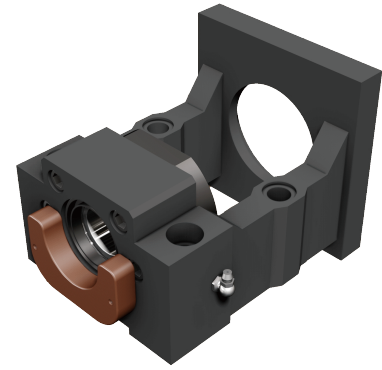

| No. | Part name | Qty |
|-----|--|------|
| 1 | Housing | 1 |
| 2 | Bearing MBCS25 with bearings 25TAC MBCS30 with bearings 30TAC MBCF30 with bearings 7206 | 1set |
| 3 | Holding lid | 1 |
| 4 | Collar | 2 |
| 5 | Seal | 2 |
| 6 | Lock nut | 1set |
| 7 | Cushion Stopper (option) | 1 |

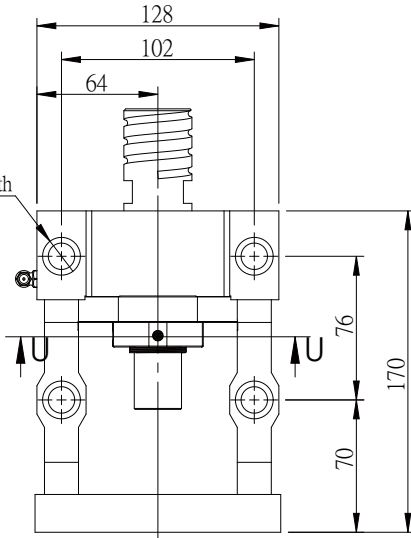
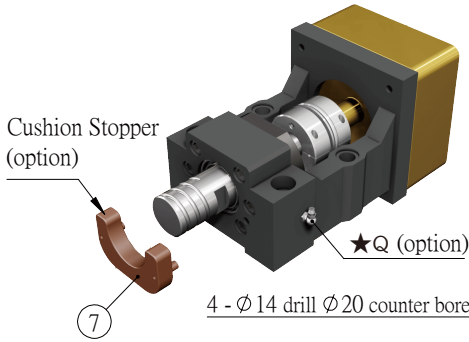
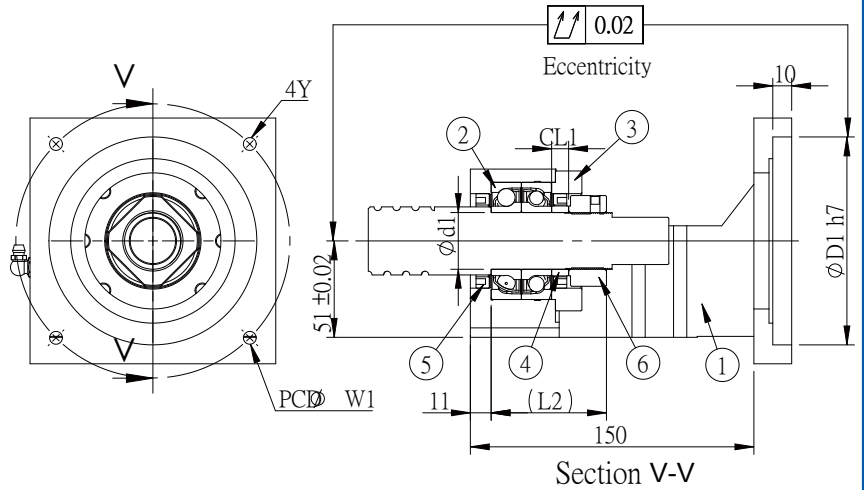
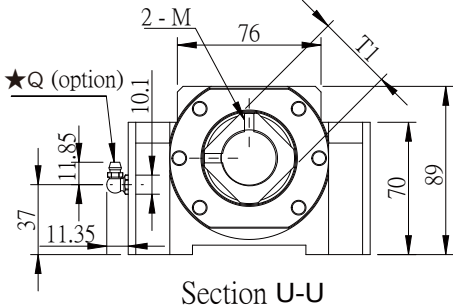

Unit : mm

| Model No. | D1 | W1 | Y | Shaft diameter d1 | CL1 | L2 | M | T1 | Q | Weight (Kgs) | Support unit | Suggest | |
|-----------|-----|-----|----|-------------------|-----|----|------|-----|---|--------------|----------------|----------|------|
| | | | | | | | | | | | Supported-side | Coupling | |
| MBCS25-Y | 95 | 115 | M8 | 25 | 15 | 65 | 4-M6 | φ45 | - | 6.75 | SBK25 SF25 | SGL 65C | |
| MBCS25-YP | | | M6 | | | | | | | | | | |
| MBCS25-S | 110 | 130 | M8 | | | | | | | | | | 6.45 |
| MBCS25-G | | 145 | M6 | | | | | | | | | | |
| MBCF30-Y | 95 | 115 | M8 | 30 | 9 | 61 | 2-M4 | □40 | - | 6.56 | BK30 BF30 | SGL 65C | |
| MBCF30-YP | | | M6 | | | | | | | | | | 6.35 |
| MBCF30-S | 110 | 130 | M8 | | | | | | | | | | - |
| MBCF30-G | | 145 | M6 | | | | | | | | | | |
| MBCS30-Y | 95 | 115 | M8 | 30 | 15 | 65 | 4-M6 | φ50 | - | 6.67 | SBK30 BF30 | SGL 65C | |
| MBCS30-YP | | | M6 | | | | | | | | | | |
| MBCS30-S | 110 | 130 | M8 | | | | | | | | | | - |
| MBCS30-G | | 145 | M6 | | | | | | | | | | |

- Note :
1. The matched bearing in the support unit has already done the preload.
 2. The matched bearings are assembled in DF way, which is the most suitable for ball screw use.
 3. The accuracy of TAC bearing is P4 grade and 7206 is P5 grade.
 4. The standard type is without Q , if required, please advise in advance.



Motor Bracket MBCS25/30 / MBCF30 (Long Type)

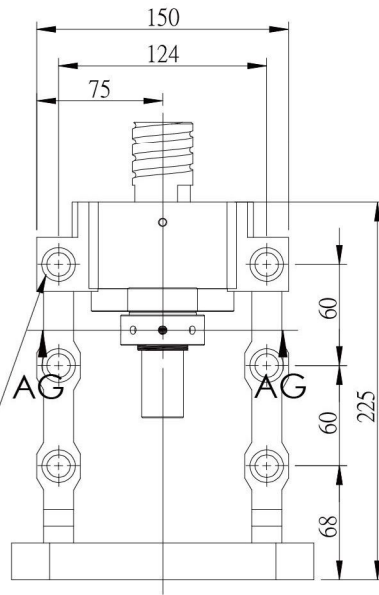
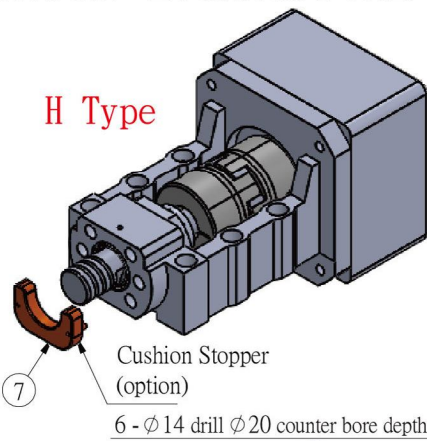

| No. | Part name | Qty |
|-----|--|------|
| 1 | Housing | 1 |
| 2 | Bearing MBCS25 with bearings 25TAC MBCS30 with bearings 30TAC MBCF30 with bearings 7206 | 1set |
| 3 | Holding lid | 1 |
| 4 | Collar | 2 |
| 5 | Seal | 2 |
| 6 | Lock nut | 1set |
| 7 | Cushion Stopper (option) | 1 |

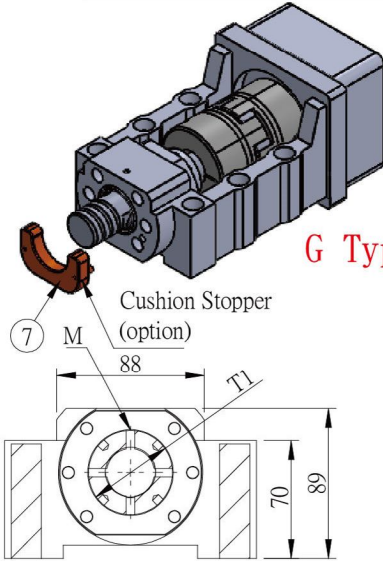

Section AG-AG

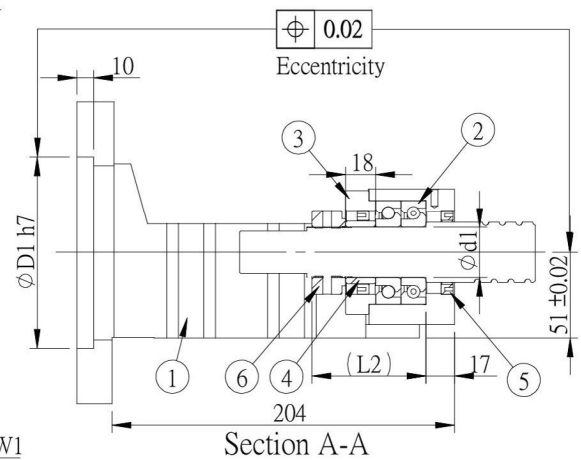
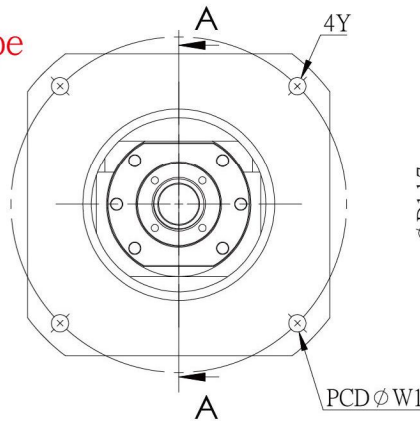

| Model No. | D1 | W1 | Y | Shaft diameter d1 | L2 | M | T1 | Weight (Kgs) | Support unit | Suggest Coupling |
|------------|-------|-----|-----|-------------------|----|----------------|----|--------------|--------------------------|--------------------------|
| | | | | | | | | | Supported-side | |
| MBCS25W-G | 110 | 145 | M8 | 25 | 68 | 4-M6 ϕ 45 | - | - | SBK25/SF25 | ROTEX GS38 |
| ※ MBCS25-I | 130 | 165 | M10 | | | | | | | ROTEX GS28 |
| ※ MBCS25-J | 150 | 185 | M10 | | | | | | | MTC-65C-RD |
| MBCS25-H | 114.3 | 200 | M12 | | | | | | | ROTEX GS28 MTC-65C-RD |
| MBCS30W-G | 110 | 145 | M8 | 30 | 68 | 4-M6 ϕ 50 | - | SBK30/BF30 | ROTEX GS38 | |
| ※ MBCS30-I | 130 | 165 | M10 | | | | | | ROTEX GS28 | |
| ※ MBCS30-J | 150 | 185 | M10 | | | | | | MTC-65C-RD | |
| MBCS30-H | 114.3 | 200 | M12 | | | | | | ROTEX GS28 MTC-65C-RD | |
| MBCF30W-G | 110 | 145 | M8 | 30 | 70 | 4-M6 ϕ 50 | - | BK30/BF30 | ROTEX GS38 | |
| ※ MBCF30-I | 130 | 165 | M10 | | | | | | ROTEX GS28 | |
| ※ MBCF30-J | 150 | 185 | M10 | | | | | | MTC-65C-RD | |
| MBCF30-H | 114.3 | 200 | M12 | | | | | | ROTEX GS28 MTC-65C-RD | |

※Customized ◦

Note : 1. The matched bearing in the support unit has already done the preload.

2. The matched bearings are assembled in DF way, which is the most suitable for ball screw use.

3. The accuracy of TAC bearing is P4 grade and 7206 is P5 grade.

Illustration for MBC30

Fixed+Fixed

Pattern : Servo motor
 YASKAWA SGMGH-05
 MITSUBISHI
 HF-SP51-81/HF-SP52-152
 DELTA G11303
 □ 130x130

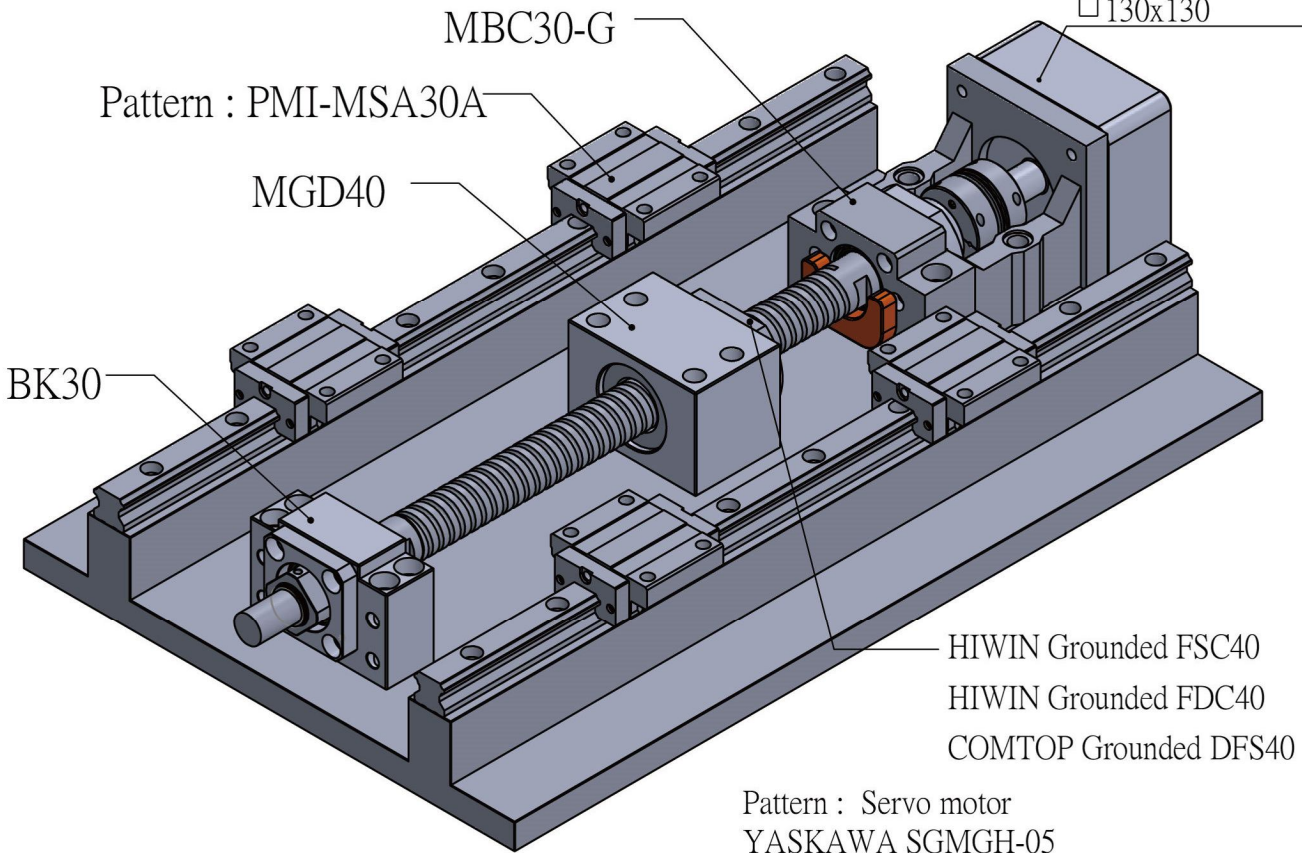

Fixed+Supported

Pattern : Servo motor
 YASKAWA SGMGH-05
 MITSUBISHI HF-SP51-81
 HF-SP52-152
 DELTA G11303
 □ 130x130

