

XYTHS620 X, Z Axis Ball Screw Actuator

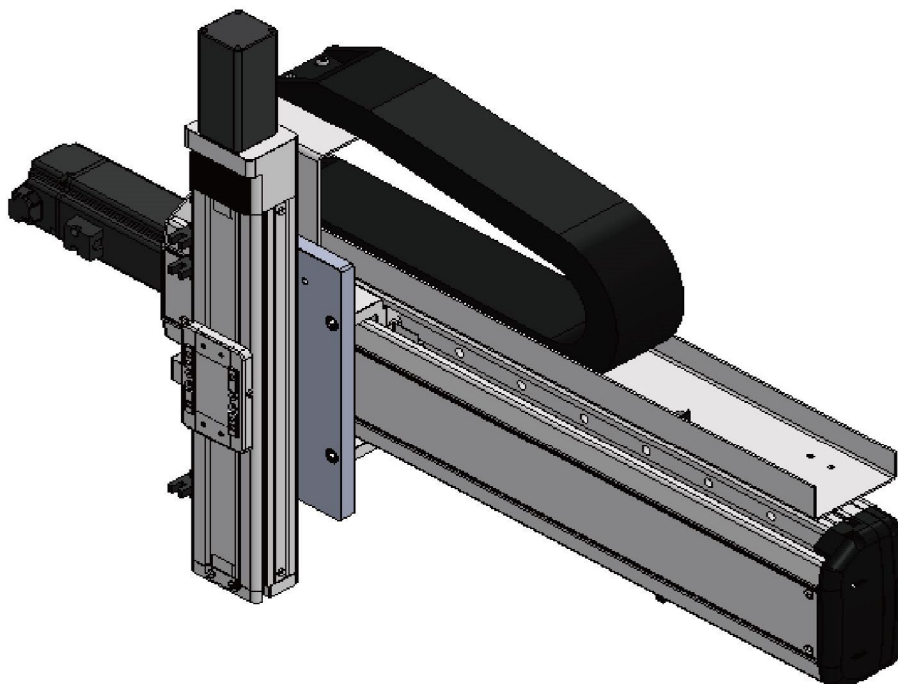

Max. Stroke

X axis 1000mm

Z axis 500mm

Max. Speed

X axis 500mm/s

Z axis 250mm/s

AC Servo Motor Power

X axis 400W

Z axis 100W

Specification

Item	X axis	Z axis
Model Type	ETHS14	ETHS6M
Repeatability (mm)	±0.01	±0.01
Lead (mm)	10	5
Max. Speed (mm/s) ※3	500	250
Stroke (Gap 100 mm)	300-1000	200-400
AC Servo Motor Power (w)	400	100
Environmen	0-40°C · 85% RH Below	

※3: The Max. speed is based on 3000RPM AC servo motor.

Max. Load Capacity

Z axis Stroke (mm)	200-400
Load Capacity of Z axis (kg)	15

ORDER CODING

XYTHS620 - F 1 - 400 - 300 - M - C - 001

Model no.

Special Order no.

■Combination	■Combination	■X-axis Stroke	■Z-axis Stroke	■Motor Brand	■Delivery Method
F XZ Axis	Direction 1 3	300-1000mm Gap 100	200-400mm Gap 100	M Mitsubishi P Panasonic Y Yaskawa T Delta	C By set K By kit

Combination Direction

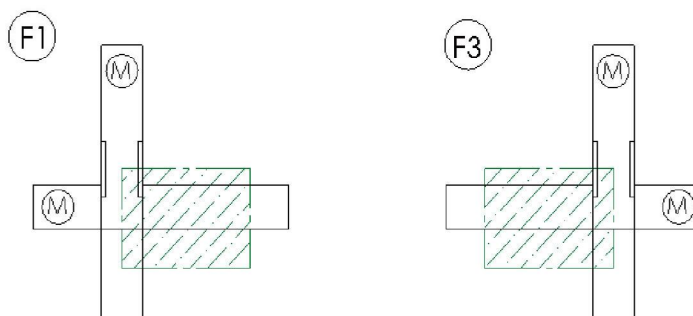

XYTHS620 X, Z Axis Ball Screw Actuator

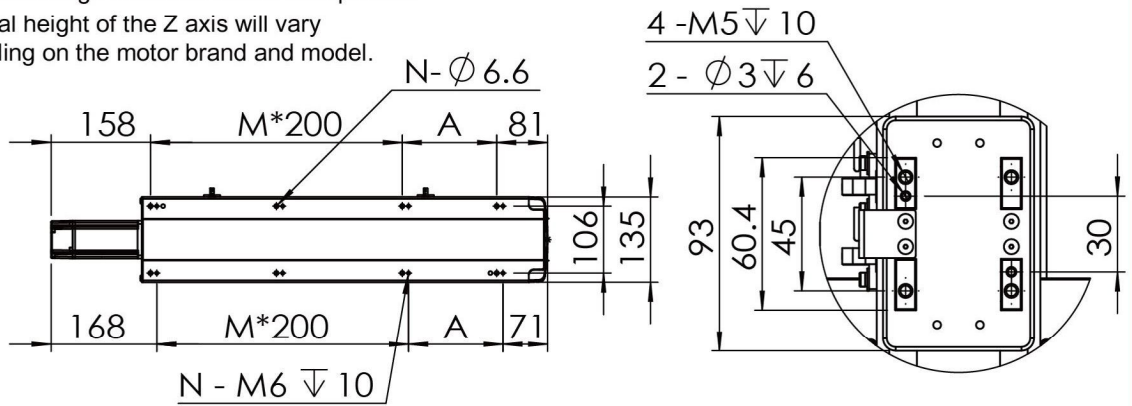
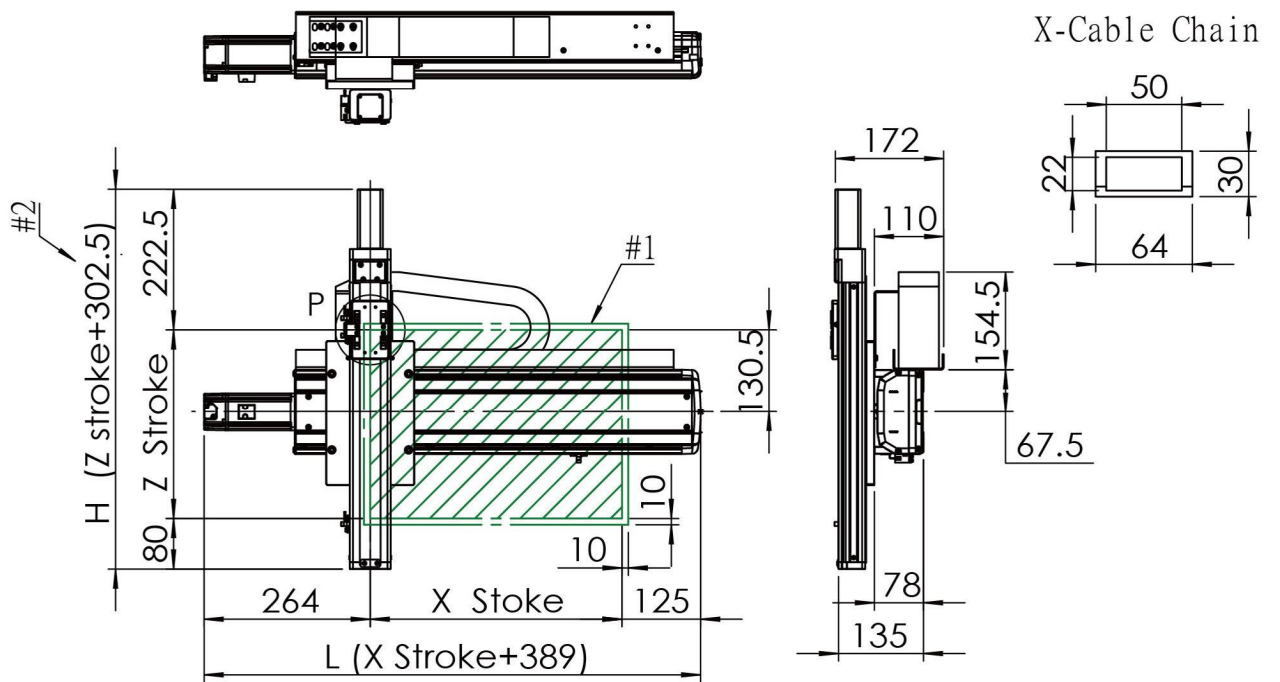

Detailed View P
 Scale 1 : 3

Unit : mm

X axis Stroke	300	400	500	600	700	800	900	1000
L	689	789	889	989	1089	1189	1289	1389
A	50	150	50	150	50	150	50	150
M	2	2	3	3	4	4	5	5
N	8	8	10	10	12	12	14	14
Max. Speed	500			450			350	250

Unit : mm

Z axis Stroke	300
H	602.5
Max. Speed	250